

17/0286 – LAND TO THE EAST OF BELLEW ROAD, DEEPCUT

Location plan

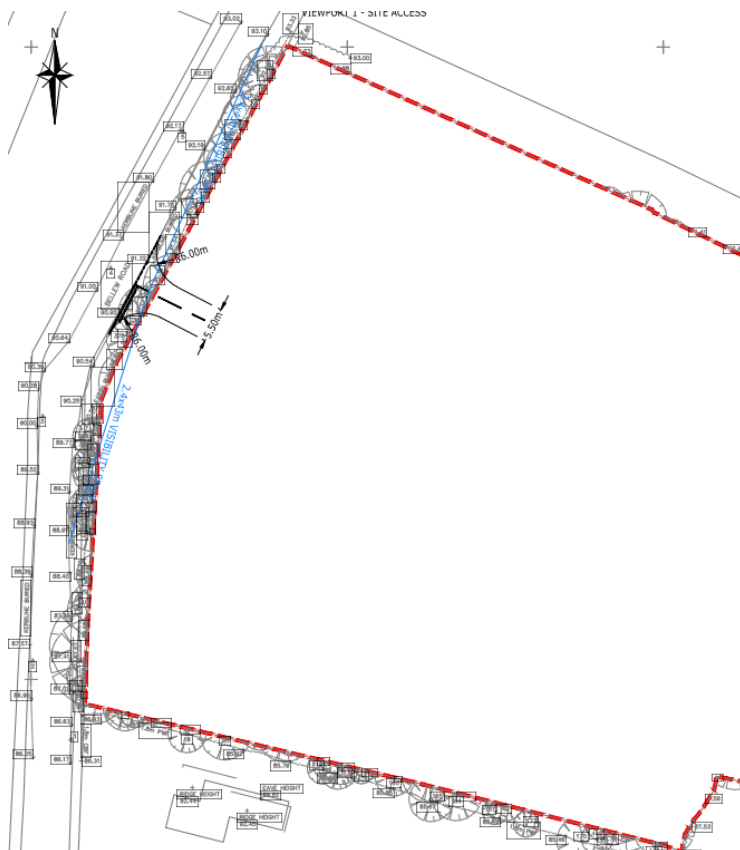

Detailed access plan showing its proposed location (for approval at this stage)



17/0286 – LAND TO THE EAST OF BELLEW ROAD, DEEPCUT





Draft illustrative masterplan (indicative only, not for approval at this stage)



17/0286 – LAND TO THE EAST OF BELLEW ROAD, DEEPCUT

Parameter plan (indicative only)



Key	
	Application Boundary
	Proposed residential road
	Proposed private structural landscape
	Proposed shared landscape
	Proposed developable area

17/0286 – LAND TO THE EAST OF BELLEW ROAD, DEEPCUT

Existing site – view from Bellew Road looking north-east



Views in the site looking north-east

17/0286 – LAND TO THE EAST OF BELLEW ROAD, DEEPCUT



17/0286 – LAND TO THE EAST OF BELLEW ROAD, DEEPCUT

Approximate location of proposed access



Looking south to boundary with The Pines



17/0286 – LAND TO THE EAST OF BELLEW ROAD, DEEPCUT

17/0286 – LAND TO THE EAST OF BELLEW ROAD, DEEPCUT

Fence on boundary with The Pines



Houses along Bellew Road



Junction of Bellew Road and Lake Road

